

# EIGHT MILE ROAD SPECIFIC PLAN

FROM  
 INTERSTATE RTE. 5 TO STATE RTE. 99  
 SAN JOAQUIN COUNTY, CALIFORNIA

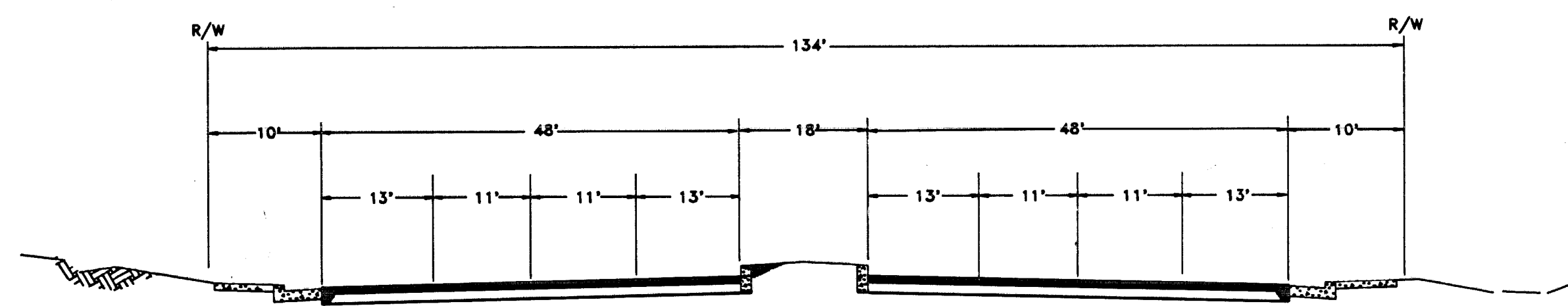
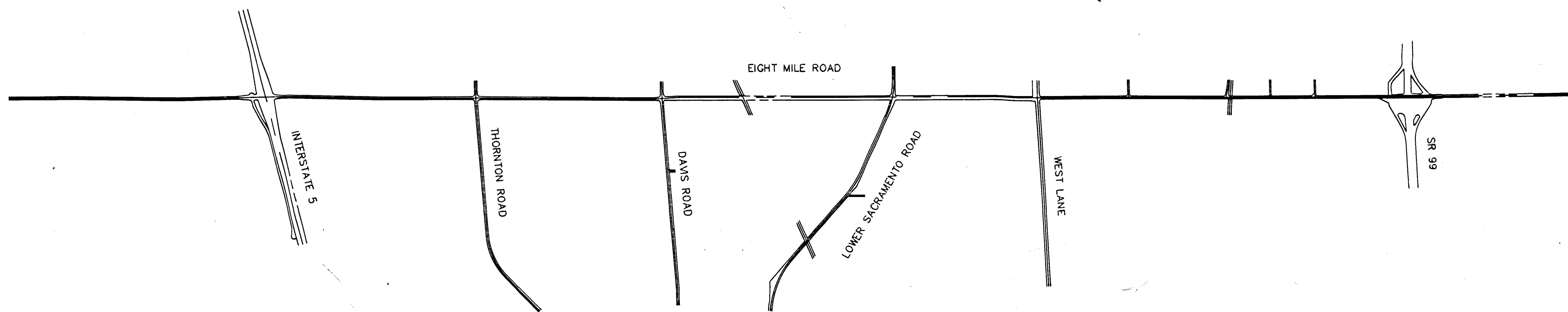
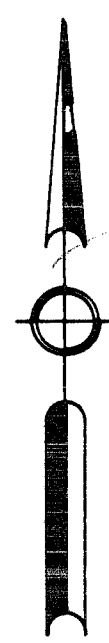

STANDARD SECTION 134' R/W  
 EIGHT MILE ROAD

NO SCALE

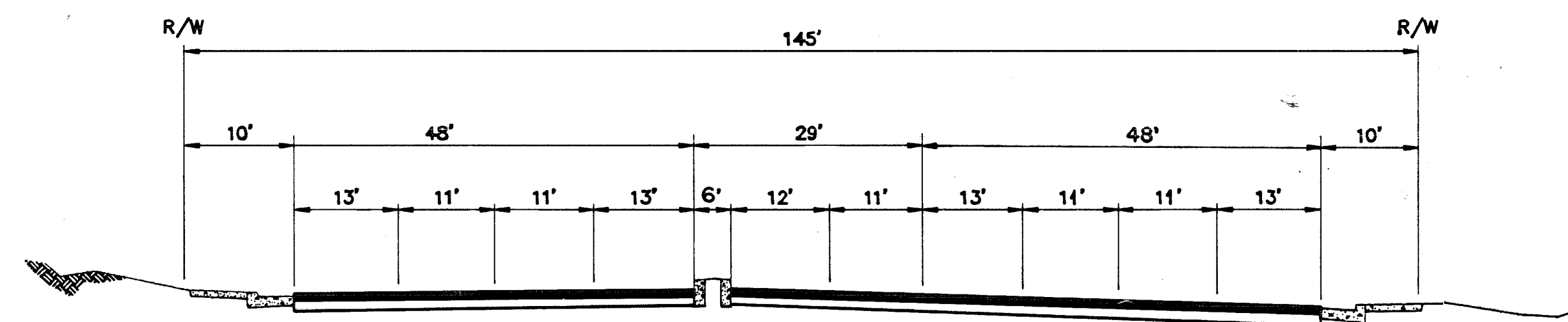

STANDARD SECTION (AT INTERSECTIONS) 145' R/W  
 EIGHT MILE ROAD

NO SCALE

|   |  |   |
|---|--|---|
| RECOMMENDED FOR APPROVAL<br><i>Henry M. Hirata</i><br>HENRY M. HIRATA<br>DIRECTOR OF PUBLIC WORKS<br>SAN JOAQUIN COUNTY | RECOMMENDED FOR APPROVAL<br><i>Sandra L. Carter</i><br>SANDRA CARTER, CHAIR<br>SAN JOAQUIN COUNTY<br>PLANNING COMMISSION | APPROVED<br><i>William N. Sousa</i><br>WILLIAM N. SOUSA, CHAIRMAN<br>SAN JOAQUIN COUNTY<br>BOARD OF SUPERVISORS<br>DATE: 10/26/93 |
| RECOMMENDED FOR APPROVAL<br><i>Paul M. Sensibaugh</i><br>PAUL M. SENSIBAUGH<br>CITY ENGINEER<br>CITY OF STOCKTON        | RECOMMENDED FOR APPROVAL<br><i>Albert Ortiz</i><br>ALBERT ORTIZ<br>CHAIRMAN, CITY OF STOCKTON<br>PLANNING COMMISSION     | APPROVED<br><i>Joan Darrah</i><br>JOAN DARRAH<br>MAYOR<br>CITY OF STOCKTON<br>DATE: 2/10/94                                       |

NOTE:  
 FUTURE ROAD OR ACCESS POINTS ARE  
 APPROXIMATE LOCATION.

| LEGEND                  |     |
|-------------------------|-----|
| EXISTING RIGHT-OF-WAY   | --- |
| CENTERLINE              | --- |
| FUTURE RIGHT-OF-WAY     | --- |
| SIGNALIZED INTERSECTION |     |
| RIGHT-IN-RIGHT-OUT ONLY |     |
| ANGLE POINTS            |     |

PREPARED BY:  
  
**omni • means**  
 ENGINEERS PLANNERS  
 SACRAMENTO Location in  
 3021 Douglas Blvd., #300 WALNUT CREEK  
 Roseville, CA 95661  
 (916) 782-8688 / 969-8688

7/6/92

3785C

3785C  
 EIGHT MILE ROAD SPECIFIC PLAN  
 FROM I-5 TO HWY 99  
 Notes: Sheets on permanent file

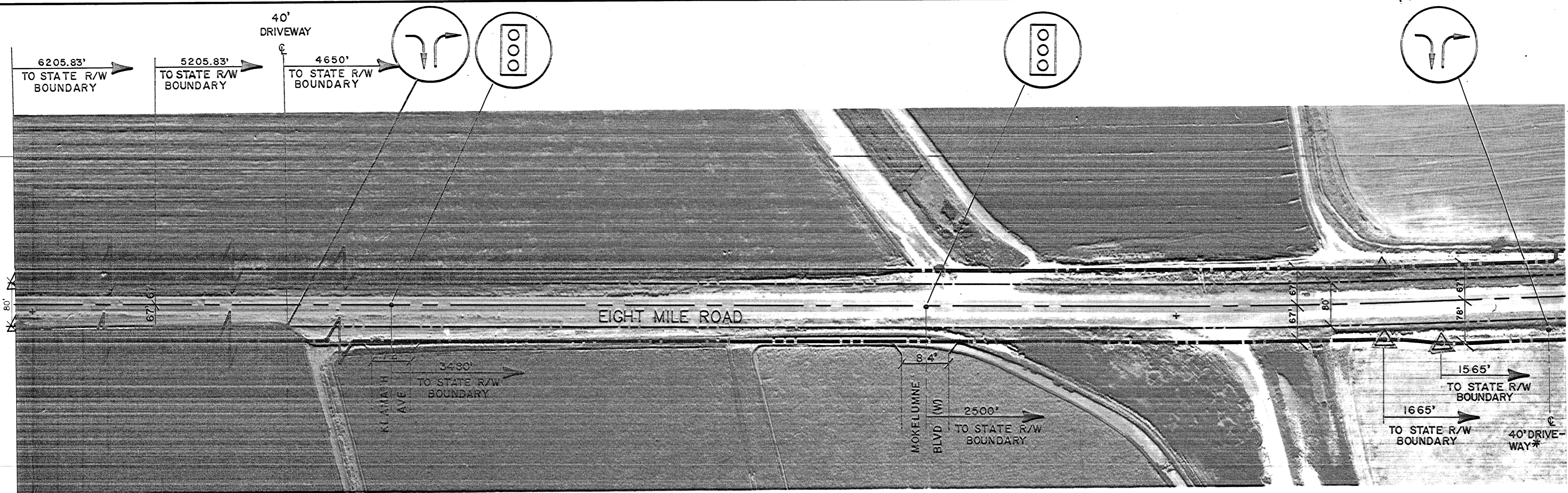

**LEGEND**

|                         |     |
|-------------------------|-----|
| EXISTING RIGHT-OF-WAY   | --- |
| CENTERLINE              | --- |
| FUTURE RIGHT-OF-WAY     | --- |
| SIGNALIZED INTERSECTION |     |
| RIGHT-IN-RIGHT-OUT ONLY |     |
| ANGLE POINTS            |     |

**NOTE:**  
 FUTURE ROAD OR ACCESS POINTS ARE APPROXIMATE LOCATION.  
 \* ADDITIONAL 11' ROW (78' HALF-SECTION) DEDICATED FOR DECELERATION/ACCELERATION LANE

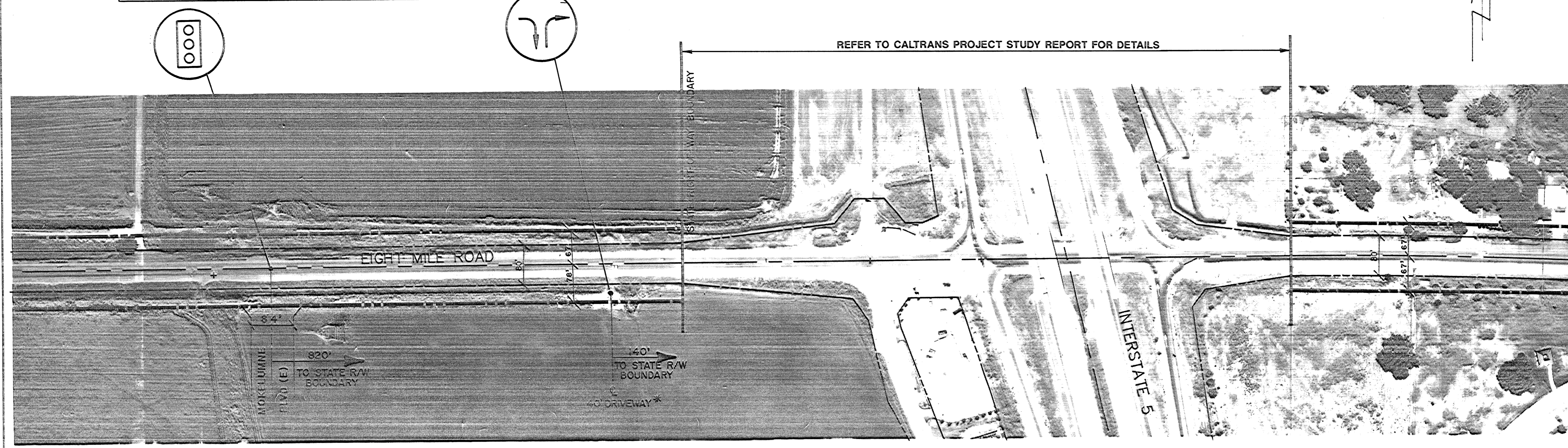

**REVISIONS**

| No. | DESCRIP. | DATE | BY |
|-----|----------|------|----|
|     |          |      |    |
|     |          |      |    |
|     |          |      |    |

SCALE 1" = 100'

**omni**  
 ENGINEERS PLANNERS

3785.1C

**EIGHT MILE ROAD SPECIFIC PLAN**  
 SAN JOAQUIN COUNTY, CALIFORNIA

|          |          |
|----------|----------|
| JOB No.  | 3610-01  |
| DESIGNED | RGB      |
| DRAWN    | EMOMSHT1 |
| COMP.    |          |
| CHECKED  |          |
| DATE     | 2-5-93   |

3785.1C  
 EIGHT MILE ROAD SPECIFIC PLAN  
 From I-5 to Hwy 99  
 Omni-Means  
 Notes: Stays on permanent file

3785.1C

| REVISIONS |          |      |
|-----------|----------|------|
| No.       | DESCRIP. | DATE |
|           |          |      |
|           |          |      |
|           |          |      |

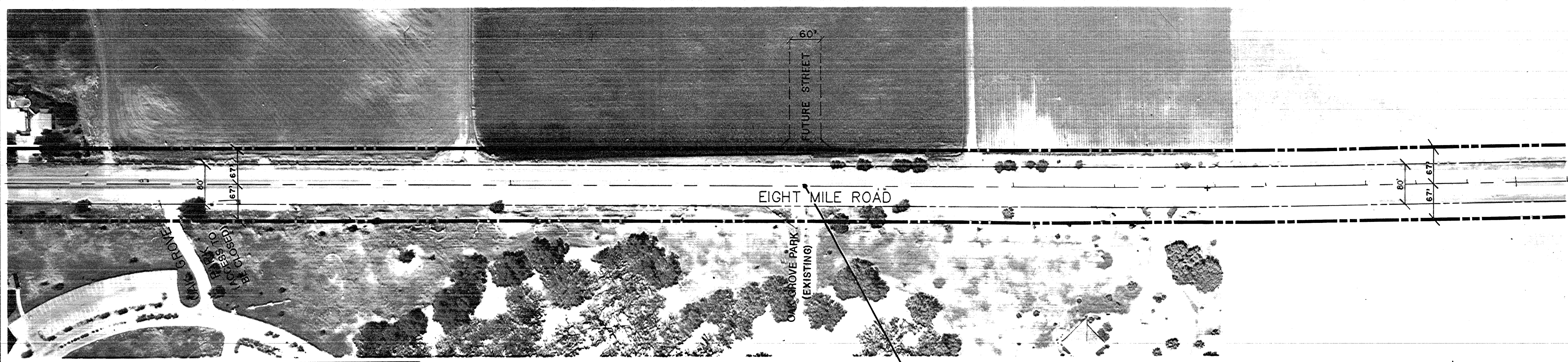

| LEGEND                  |     |
|-------------------------|-----|
| EXISTING RIGHT-OF-WAY   | --- |
| CENTERLINE              | --- |
| FUTURE RIGHT-OF-WAY     | --- |
| SIGNALIZED INTERSECTION |     |
| RIGHT-IN-RIGHT-OUT ONLY |     |
| ANGLE POINTS            |     |

NOTE:  
 FUTURE ROAD OR ACCESS POINTS ARE APPROXIMATE LOCATION.  
 \* ADDITIONAL 11' ROW (78' HALF-SECTION) DEDICATED FOR DECELERATION/ACCELERATION LANE

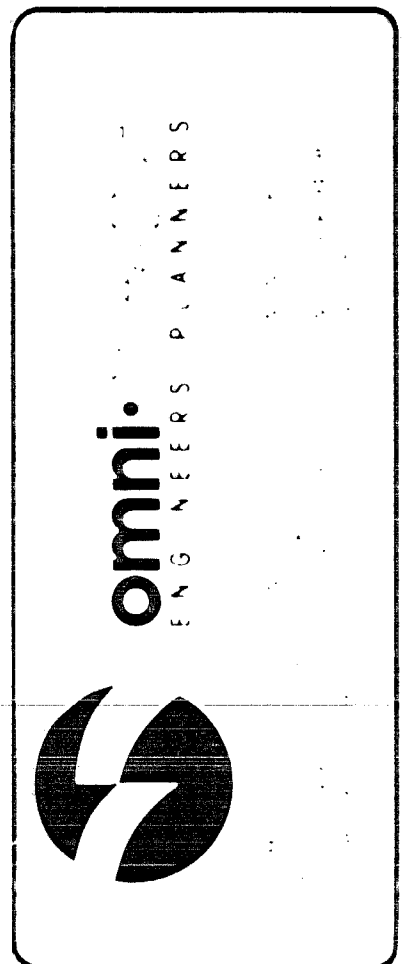
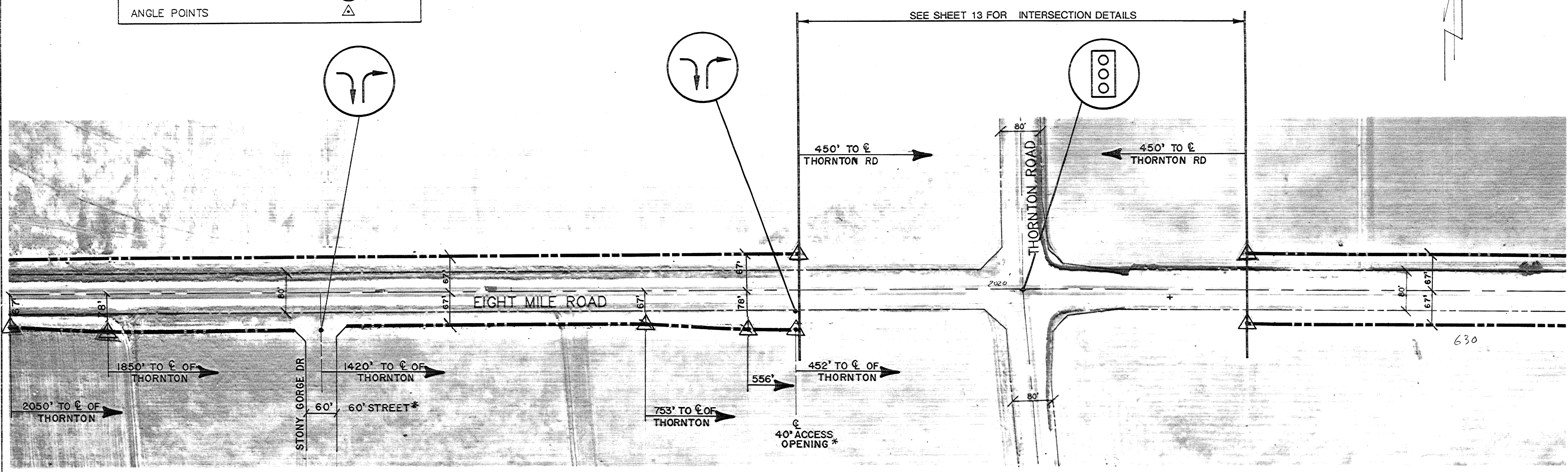
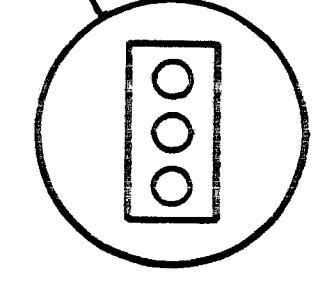

**EIGHT MILE ROAD SPECIFIC PLAN**  
 SAN JOAQUIN COUNTY, CALIFORNIA

|          |         |
|----------|---------|
| DATE     | 3-21-93 |
| DESIGNER | HGR     |
| CHECKER  | LM,MSH  |
| DATE     | 2-5-93  |

2 / 17

3785.2C

3785.2C  
 EIGHT MILE ROAD SPECIFIC PLAN  
 From 1-5 to Hwy 99  
 Omni-Means  
 Note: Stays on Attachment File

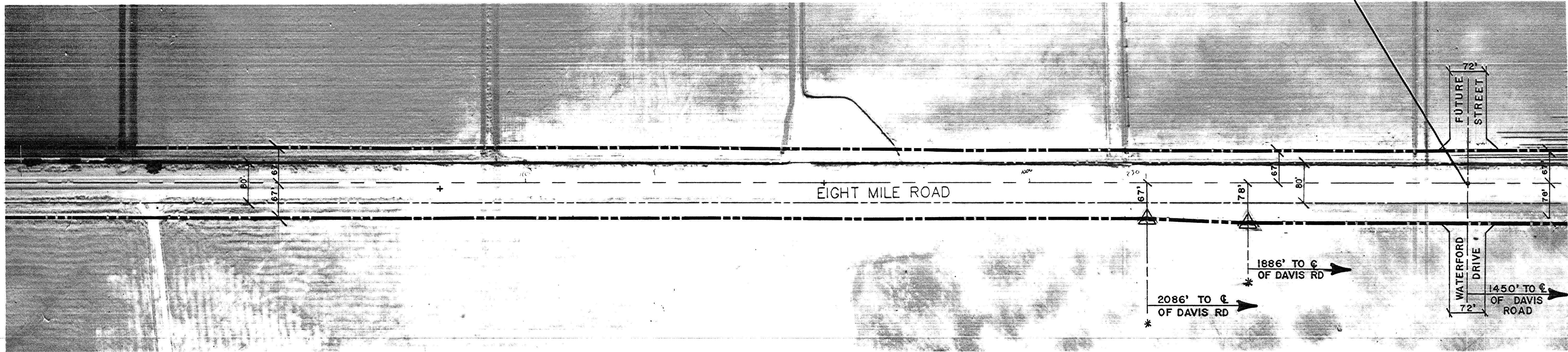

| LEGEND                  |     |
|-------------------------|-----|
| EXISTING RIGHT-OF-WAY   | --- |
| CENTERLINE              | --- |
| FUTURE RIGHT-OF-WAY     | --- |
| SIGNALIZED INTERSECTION |     |
| RIGHT-IN-RIGHT-OUT ONLY |     |
| ANGLE POINTS            |     |

NOTE:

FUTURE ROAD OR ACCESS POINTS ARE APPROXIMATE LOCATION.

\* ADDITIONAL 11' ROW (78' HALF-SECTION) DEDICATED FOR DECELERATION/ACCELERATION LANE

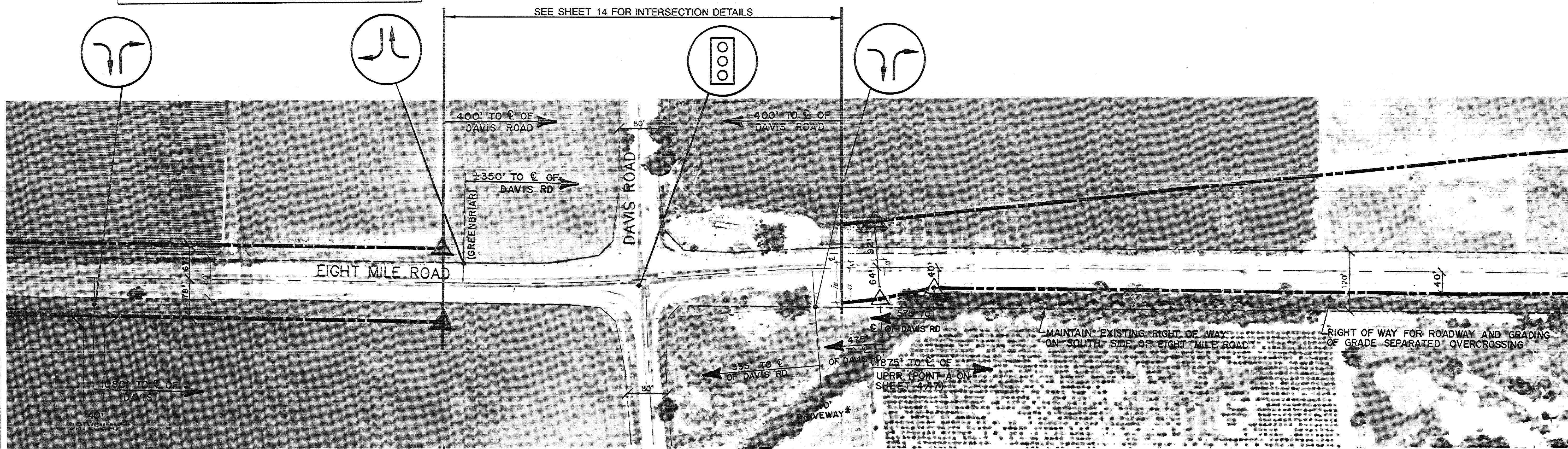

| REVISIONS |          |      |
|-----------|----------|------|
| No.       | DESCRIP. | DATE |
|           |          |      |
|           |          |      |
|           |          |      |
|           |          |      |
|           |          |      |

SCALE 1" = 100'



**EIGHT MILE ROAD SPECIFIC PLAN**  
 SAN JOAQUIN COUNTY, CALIFORNIA

|      |         |
|------|---------|
| HN:  | 3610-01 |
| INT: | RGB     |
| RAW: | ENOMSH1 |
| MI:  |         |
| HT:  |         |
| AT:  | 2-5-93  |

3 / 17  
 OF

3785.3C

3785.3C  
 EIGHT MILE ROAD SPECIFIC PLAN  
 From 1-5 to Hwy 99  
 Omni-Means  
 2-16-94  
 Note: Stays on permanent file

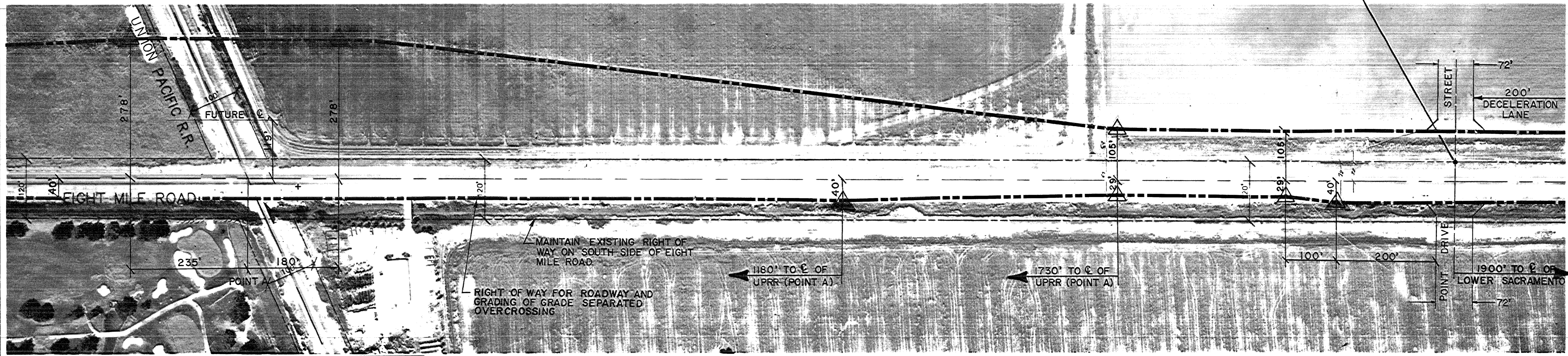

| LEGEND                  |  |
|-------------------------|--|
| EXISTING RIGHT-OF-WAY   |  |
| CENTERLINE              |  |
| FUTURE RIGHT-OF-WAY     |  |
| SIGNALIZED INTERSECTION |  |
| RIGHT-IN-RIGHT-OUT ONLY |  |
| ANGLE POINTS            |  |

NOTE:  
 FUTURE ROAD OR ACCESS POINTS ARE APPROXIMATE LOCATION.  
 \* ADDITIONAL 11' ROW (78' HALF-SECTION) DEDICATED FOR DECELERATION/ACCELERATION LANE

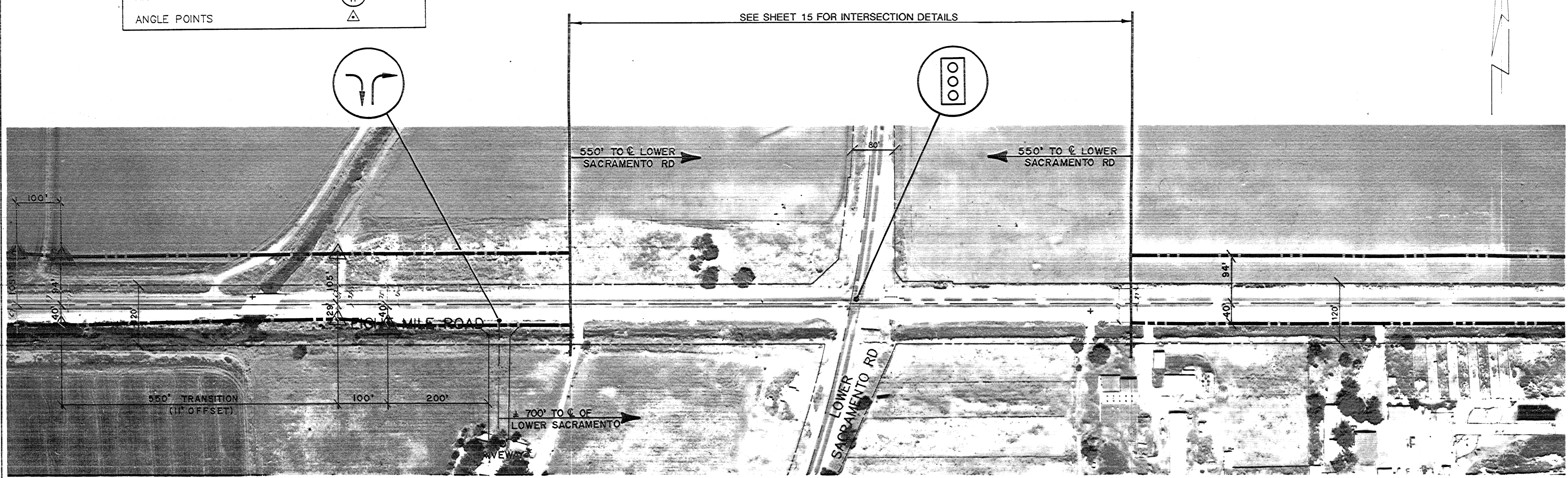

| REVISIONS |          |      |    |
|-----------|----------|------|----|
| NO.       | DESCRIP. | DATE | BY |
|           |          |      |    |
|           |          |      |    |
|           |          |      |    |

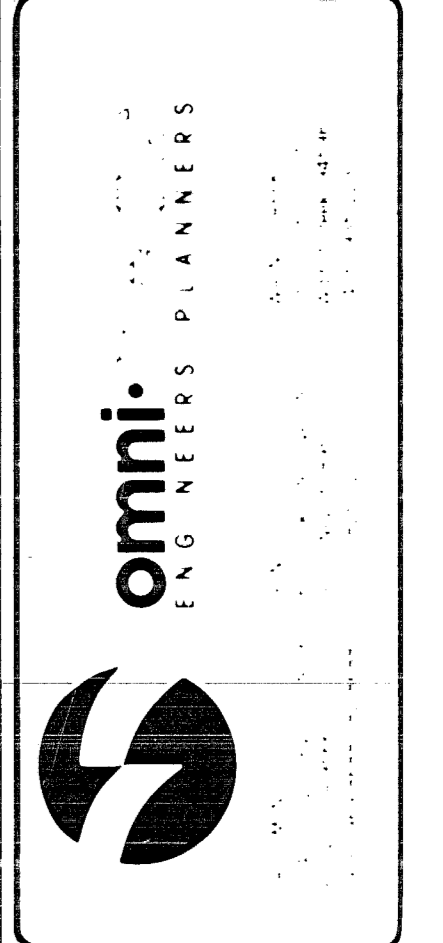
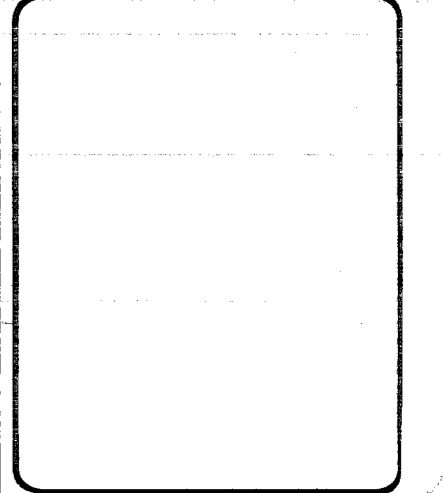

**EIGHT MILE ROAD SPECIFIC PLAN**  
 SAN JOAQUIN COUNTY, CALIFORNIA

|          |        |
|----------|--------|
| DATE     | 2-5-93 |
| BY       |        |
| CHECKED  |        |
| DESIGNED |        |
| PLANNED  |        |
|          |        |

4  
 17

3785.4C  
 EIGHT MILE ROAD SPECIFIC PLAN  
 Lower Sacramento Hwy 216-94  
 Notes: Stays on permanent file

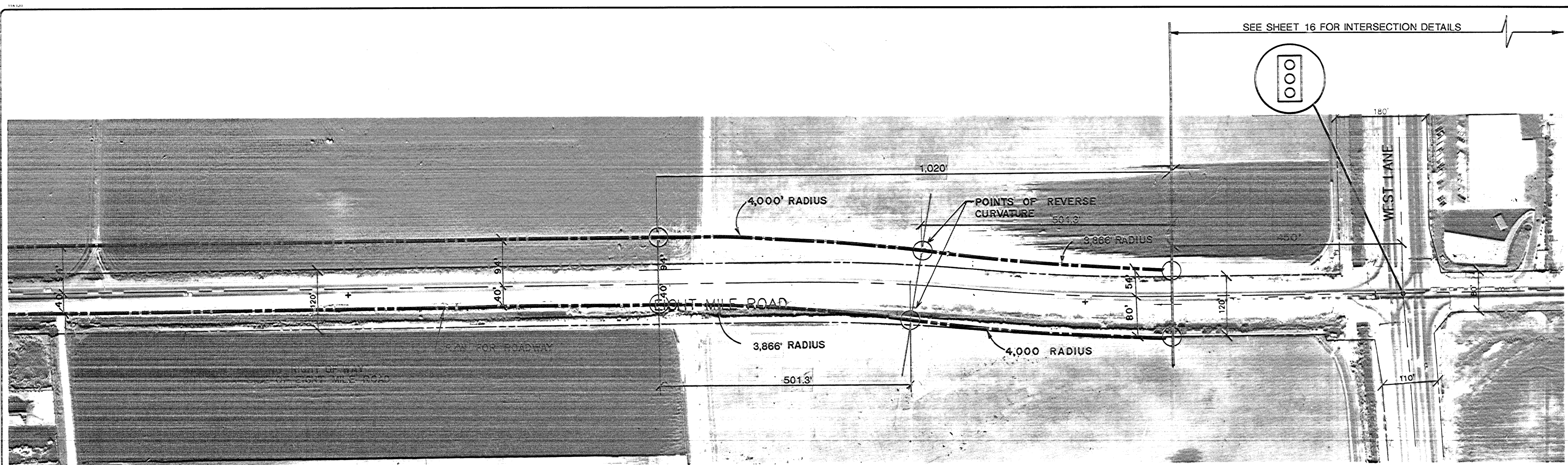

SEE SHEET 16 FOR INTERSECTION DETAILS

| LEGEND                  |     |
|-------------------------|-----|
| EXISTING RIGHT-OF-WAY   | --- |
| CENTERLINE              | --- |
| FUTURE RIGHT-OF-WAY     | --- |
| SIGNALIZED INTERSECTION |     |
| RIGHT-IN-RIGHT-OUT ONLY |     |
| ANGLE POINTS            |     |

NOTE:  
 FUTURE ROAD OR ACCESS POINTS ARE APPROXIMATE LOCATION.  
 \* ADDITIONAL 11' ROW (78" HALF-SECTION) DEDICATED FOR DECELERATION/ACCELERATION LANE

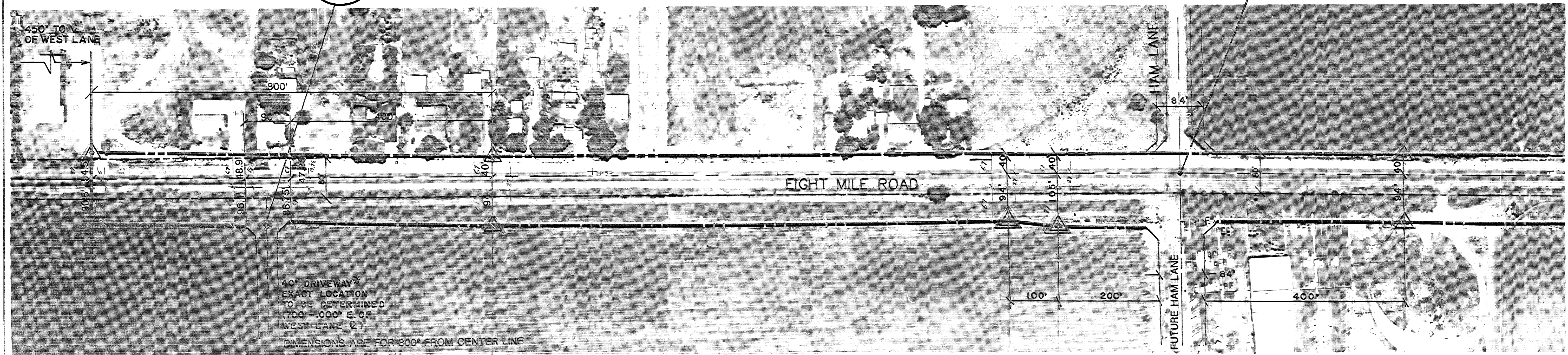

40' DRIVEWAY\*  
 EXACT LOCATION TO BE DETERMINED (700'-1000' E. OF WEST LANE C)  
 DIMENSIONS ARE FOR 300' FROM CENTER LINE

| REVISIONS |          |      |    |
|-----------|----------|------|----|
| NO.       | DESCRIP. | DATE | BY |
|           |          |      |    |

SCALE 1" = 100'

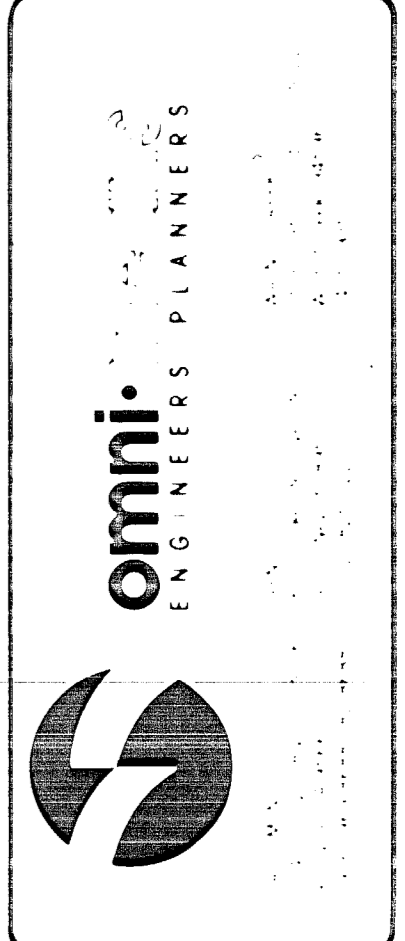

**EIGHT MILE ROAD SPECIFIC PLAN**  
 SAN JOAQUIN COUNTY, CALIFORNIA

|             |         |
|-------------|---------|
| DESIGNED BY | SP1/001 |
| CHECKED BY  | HGP     |
| DRAWN BY    | EMUMSHT |
| DATE        | 2-5-93  |

SHEET NO.  
**5**  
 OF  
**17**

3785.5C  
 EIGHT MILE ROAD SPECIFIC PLAN  
 From I-5 to Hwy 99  
 Omni-Means 2-16-94  
 Note: Stays on Permanent File

3785.5C

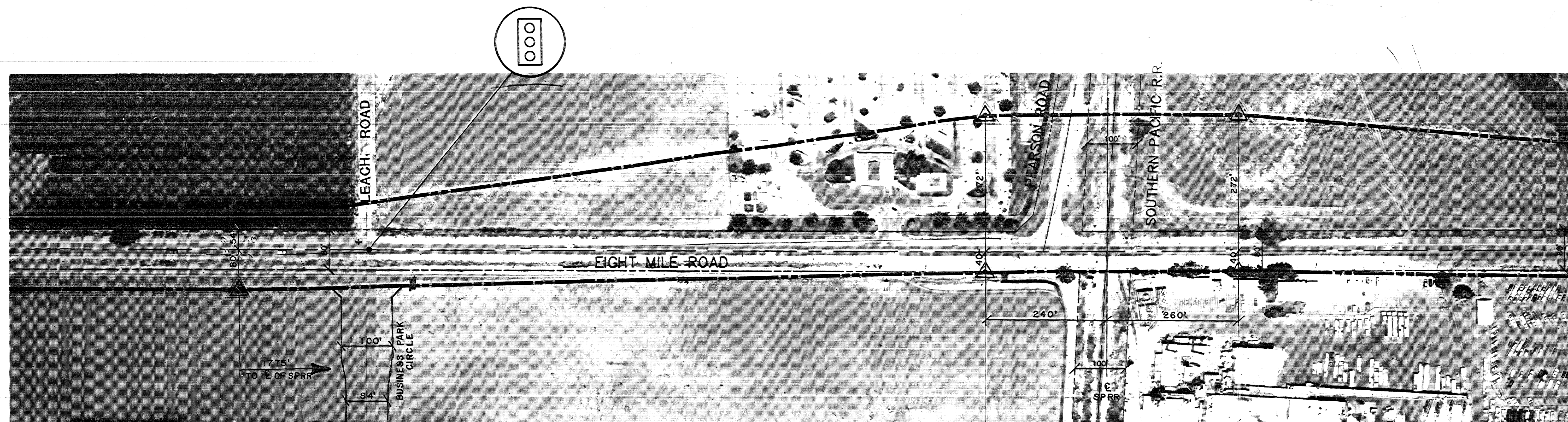

| LEGEND                  |     |
|-------------------------|-----|
| EXISTING RIGHT-OF-WAY   | --- |
| CENTERLINE              | --- |
| FUTURE RIGHT-OF-WAY     | --- |
| SIGNALIZED INTERSECTION |     |
| RIGHT-IN-RIGHT-OUT ONLY |     |
| ANGLE POINTS            |     |

NOTE:  
 FUTURE ROAD OR ACCESS POINTS ARE APPROXIMATE LOCATION.  
 \* ADDITIONAL 11' ROW (78' HALF-SECTION) DEDICATED FOR DECELERATION/ACCELERATION LANE

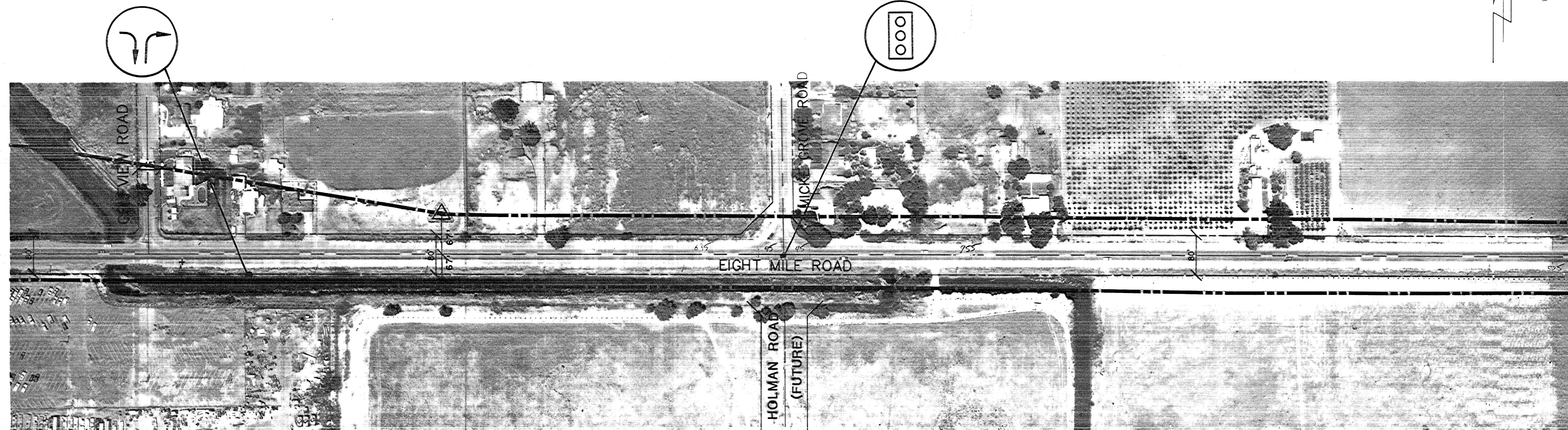

| REVISIONS |          |      |    |
|-----------|----------|------|----|
| No.       | DESCRIP. | DATE | BY |
|           |          |      |    |
|           |          |      |    |
|           |          |      |    |

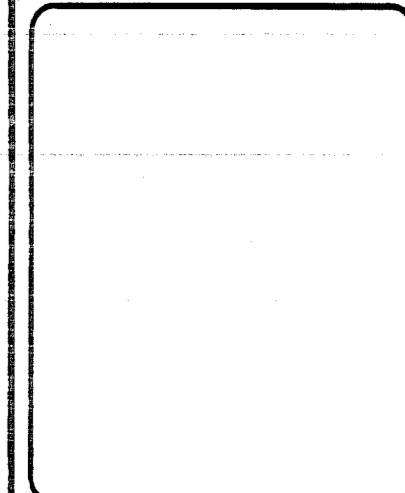

660  
 omni  
 ENGINEERS PLANNERS  
 1000 N. GATEWAY AVENUE  
 SUITE 100  
 SAN JOAQUIN, CA 95326  
 (916) 486-1000  
 FAX (916) 486-1001  
 WWW.OMNI-ENG.COM

**EIGHT MILE ROAD SPECIFIC PLAN**  
 SAN JOAQUIN COUNTY, CALIFORNIA

|          |          |
|----------|----------|
| DATE     | 2-5-93   |
| CHECKED  |          |
| DRAWN    | EMUMSHT1 |
| DESIGNED | RGB      |
| FIRM NO. | 3610-01  |

SHEET NO.  
 6  
 OF  
 17

3785.6C  
 EIGHT MILE ROAD SPECIFIC PLAN  
 FROM 1-5 TO HWY 99  
 Omni-Engineers 2-16-94  
 Note: Stays on permanent file

3

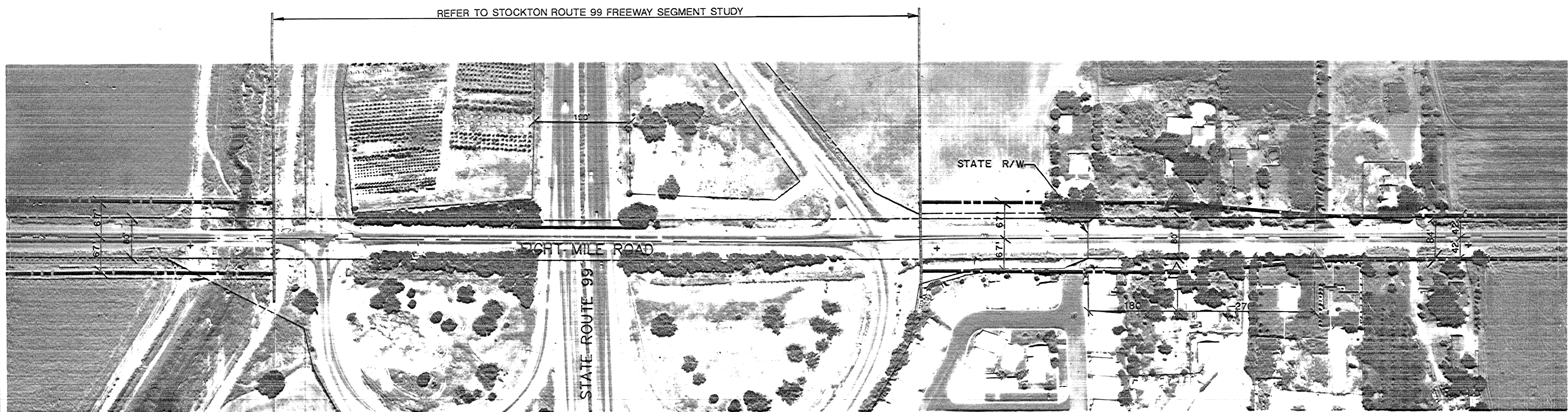

| LEGEND                  |     |
|-------------------------|-----|
| EXISTING RIGHT-OF-WAY   | --- |
| CENTERLINE              | --- |
| FUTURE RIGHT-OF-WAY     | --- |
| SIGNALIZED INTERSECTION |     |
| RIGHT-IN-RIGHT-OUT ONLY |     |
| ANGLE POINTS            |     |

NOTE:  
 FUTURE ROAD OR ACCESS POINTS ARE APPROXIMATE LOCATION.  
 \* ADDITIONAL 11' ROW (78' HALF-SECTION) DEDICATED FOR DECELERATION/ACCELERATION LANE

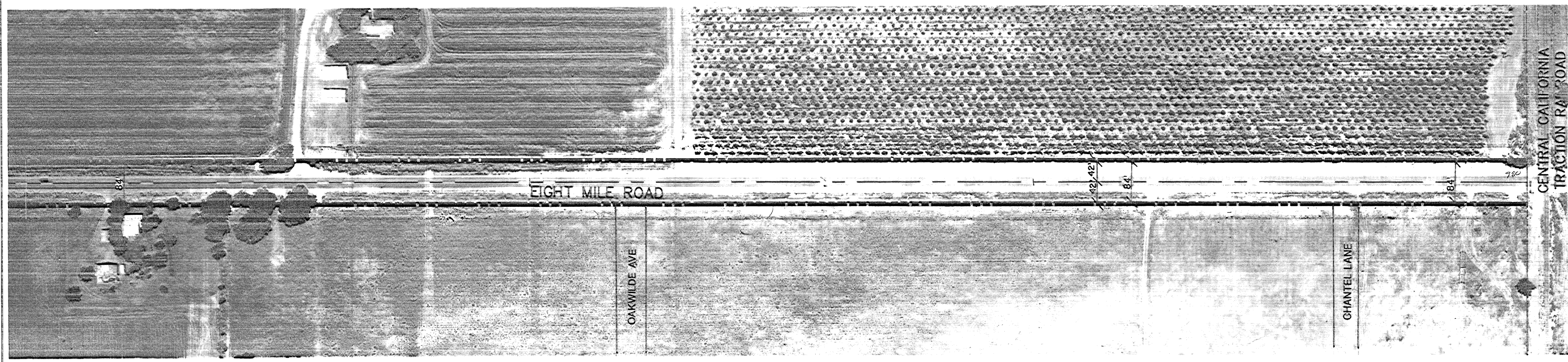

| REVISIONS |          |      |    |
|-----------|----------|------|----|
| NO.       | DESCRIP. | DATE | BY |
|           |          |      |    |

N.A.E. 1" = 100'

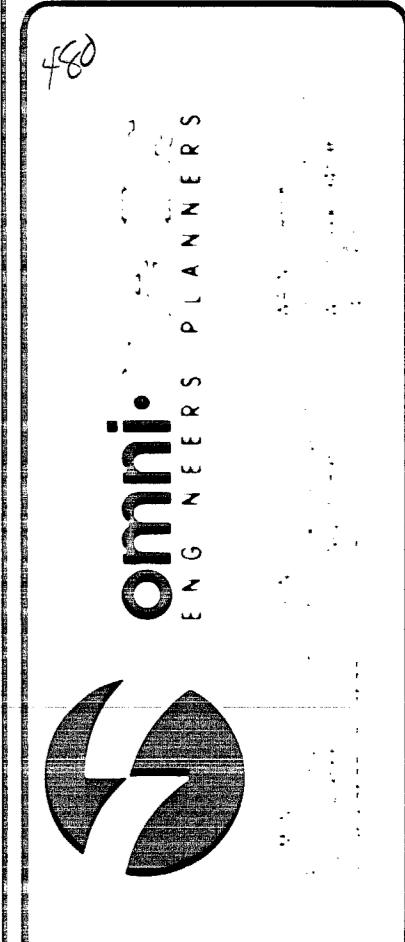

**EIGHT MILE ROAD SPECIFIC PLAN**  
 SAN JOAQUIN COUNTY, CALIFORNIA

DATE: 2-5-93  
 DRAWN BY: EMUMSHY  
 CHECKED BY: RGP  
 DESIGNED BY: SP1

7 OF 17

3785.7C  
 EIGHT MILE ROAD SPECIFIC PLAN  
 San Joaquin County  
 Date: 2-16-94  
 Note: Stays on Permanent File

3785.7C





| LEGEND                |           |
|-----------------------|-----------|
| EXISTING RIGHT-OF-WAY | —————     |
| CENTERLINE            | - - - - - |

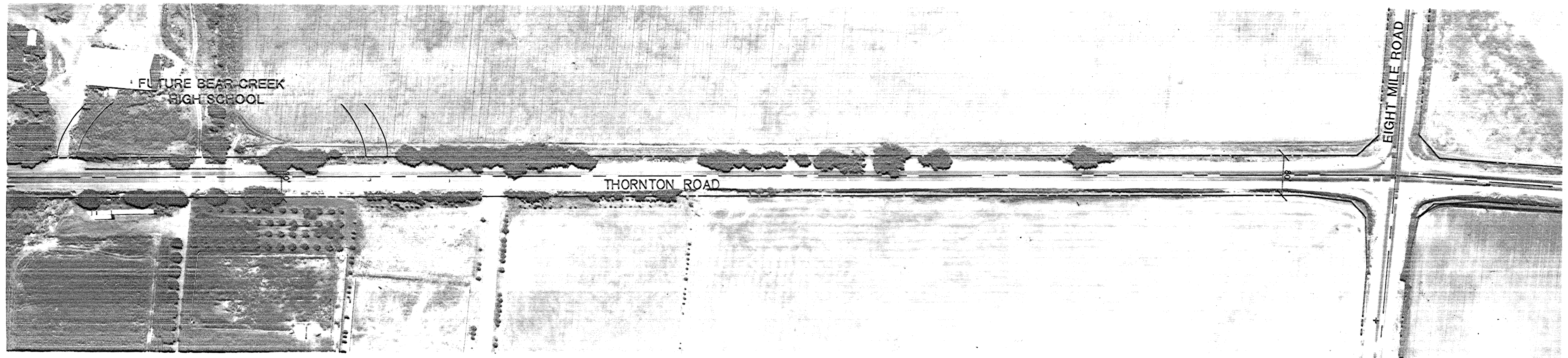

| REVISIONS |          |      |    |
|-----------|----------|------|----|
| NO.       | DESCRIP. | DATE | BY |
|           |          |      |    |
|           |          |      |    |

SCALE 1" = 100'

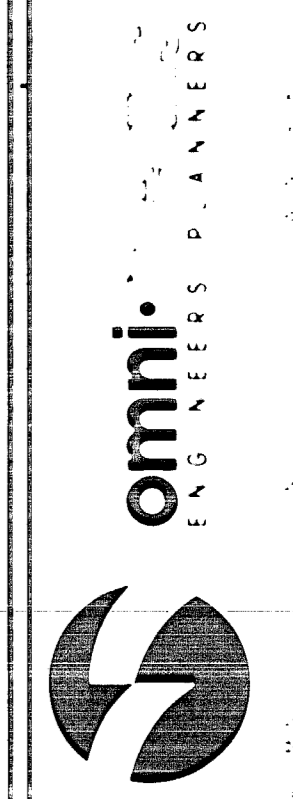

**EIGHT MILE ROAD SPECIFIC PLAN**  
 SAN JOAQUIN COUNTY, CALIFORNIA

DATE: 8/13/89  
 DRAWN: EMUMSH  
 CHECKED: 1-30-89

8 / 17

3785.3C

3785.3C  
 EIGHT MILE ROAD SPECIFIC PLAN  
 FROM L-5 TO HWY 21 & 94  
 FINAL SHEETS  
 NOTES: SHEETS ON PERMITS FILE

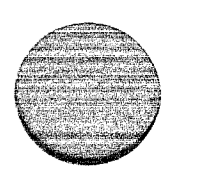

8/13/89



| LEGEND                |       |
|-----------------------|-------|
| EXISTING RIGHT-OF-WAY | ----- |
| CENTERLINE            | ----- |



| REVISIONS |          |      |    |
|-----------|----------|------|----|
| No.       | DESCRIP. | DATE | BY |
|           |          |      |    |
|           |          |      |    |
|           |          |      |    |
|           |          |      |    |
|           |          |      |    |
|           |          |      |    |
|           |          |      |    |
|           |          |      |    |
|           |          |      |    |
|           |          |      |    |

SCALE 1" = 100'

**omni·means**  
ENGINEERS PLANNERS

1000 N. GARDEN ST., SUITE 100  
SANTA ANA, CA 92705  
TEL: 714/952-1111  
FAX: 714/952-1112  
WWW.OMNIMEANS.COM

**EIGHT MILE ROAD SPECIFIC PLAN**  
SAN JOAQUIN COUNTY, CALIFORNIA

|          |           |
|----------|-----------|
| JOB No.  | 5610-01   |
| DESIGNED | RGR       |
| DRAWN    | EMUM/GHT1 |
| CHECKED  |           |
| DATE     | 1-30-89   |

SHEET No.  
**9**  
OF  
**17**

3725:9C

3725:9C  
EIGHT MILE ROAD SPECIFIC PLAN  
FROM 1-5 TO HWY 99  
OMNI-MEANS 2-16-94  
NOTICE: STAYS ON PERMANENT FILE

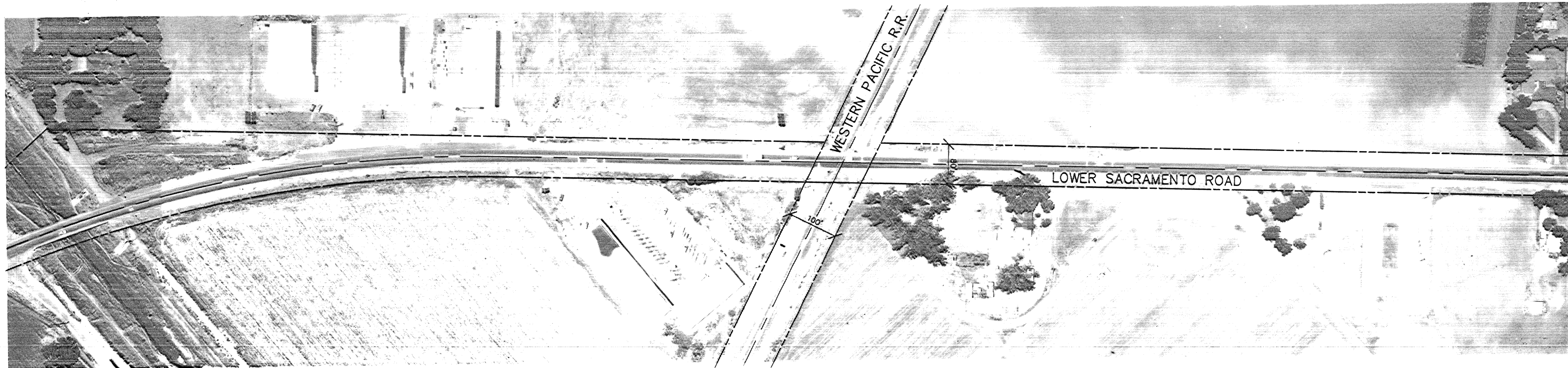

| LEGEND                |     |
|-----------------------|-----|
| EXISTING RIGHT-OF-WAY | --- |
| CENTERLINE            | --- |

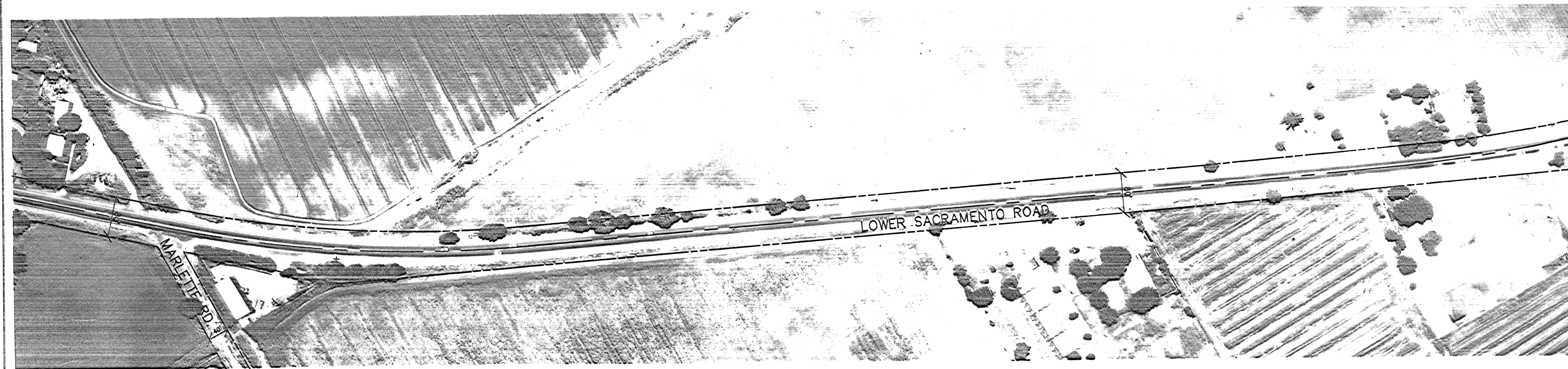

| REVISIONS |          |      |    |
|-----------|----------|------|----|
| No.       | DESCRIP. | DATE | BY |
|           |          |      |    |
|           |          |      |    |
|           |          |      |    |
|           |          |      |    |
|           |          |      |    |

SCALE 1" = 100'

**omni-means**  
ENGINEERS PLANNERS

8141  
2740 Douglas Blvd. Suite 260  
Sacramento, CA 95820  
916 486-8600 FAX 916 486-8600

WALNUT CREEK  
2000 Camino Diablo, Suite 220  
Walnut Creek, CA 94595  
916 935-7336

**EIGHT MILE ROAD SPECIFIC PLAN**  
SAN JOAQUIN COUNTY, CALIFORNIA

|          |         |
|----------|---------|
| JOB No.  | 3610-01 |
| DESIGNED | RGB     |
| DRAWN    | EMOMSH1 |
| COMP     |         |
| CHECKED  |         |
| DATE     | 1-30-89 |

SHEET No.  
**10**  
of  
**17**

3785.10C  
EIGHT MILE ROAD SPECIFIC PLAN  
FROM I-5 to Hwy 99  
Omni-Means  
2-16-94  
NOTE: Stays on Permanent File

3785.10C

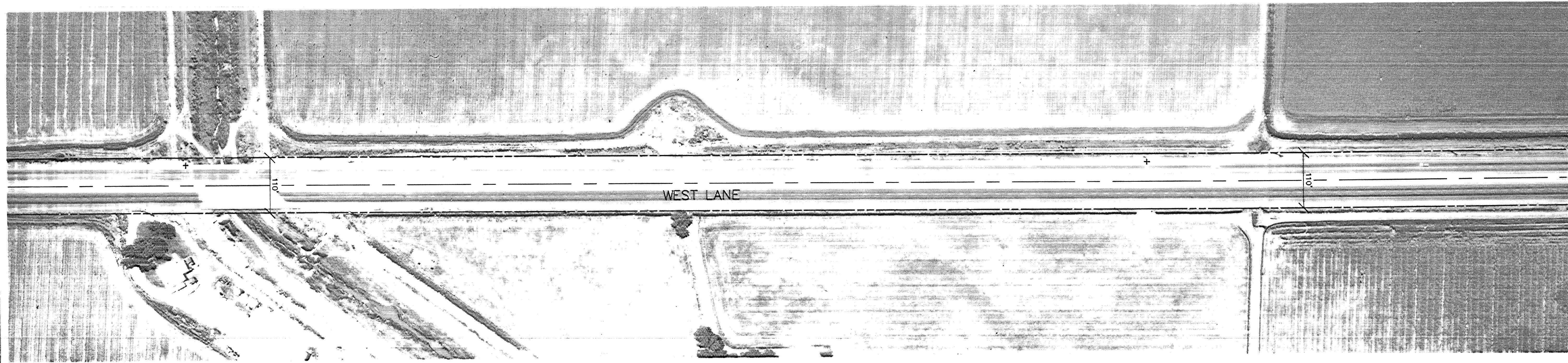

| LEGEND                |       |
|-----------------------|-------|
| EXISTING RIGHT-OF-WAY | ————— |
| CENTERLINE            | ----- |

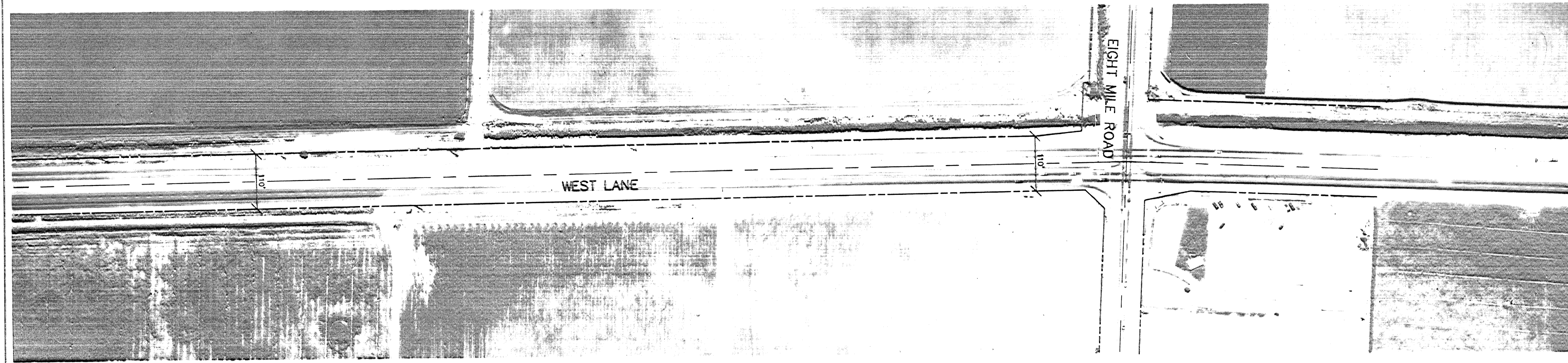

| REVISIONS |          |      |    |
|-----------|----------|------|----|
| No.       | DESCRIP. | DATE | BY |
|           |          |      |    |
|           |          |      |    |
|           |          |      |    |
|           |          |      |    |

SCALE 1" = 100'

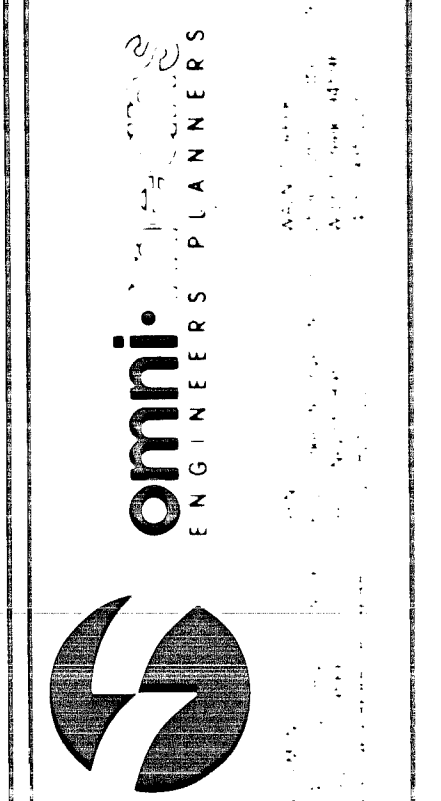

**EIGHT MILE ROAD SPECIFIC PLAN**  
 SAN JOAQUIN COUNTY, CALIFORNIA

|          |          |
|----------|----------|
| DATE     | 11/17/99 |
| BY       |          |
| CHECKED  |          |
| APPROVED |          |

11 / 17

3785.11C

3785.11C  
 EIGHT MILE ROAD SPECIFIC PLAN  
 From I-5 to Hwy 99  
 Omni-Means  
 Note: Stays on Permanent File

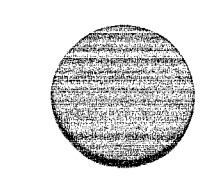



| LEGEND                |       |
|-----------------------|-------|
| EXISTING RIGHT-OF-WAY | ----- |
| CENTERLINE            | ————— |

| REVISIONS |          |      |    |
|-----------|----------|------|----|
| No.       | DESCRIP. | DATE | BY |
|           |          |      |    |
|           |          |      |    |
|           |          |      |    |
|           |          |      |    |
|           |          |      |    |
|           |          |      |    |
|           |          |      |    |
|           |          |      |    |
|           |          |      |    |
|           |          |      |    |

SCALE 1" = 50'

**omni-means**  
ENGINEERS-PLANNERS

WALNUT CREEK  
2500 Jamboree Road, Suite 220  
Walnut Creek, CA 94595-2720  
Tel: 925-935-2720  
Fax: 925-935-2720

REVISION  
6/17/11 (update Draw No. 100)  
2/8/11 (update Draw No. 100)  
1/27/11 (update Draw No. 100)  
1/27/11 (update Draw No. 100)  
1/27/11 (update Draw No. 100)

**EIGHT MILE ROAD SPECIFIC PLAN**  
SAN JOAQUIN COUNTY, CALIFORNIA

|          |           |
|----------|-----------|
| JOB No.  | 3610-01   |
| DESIGNED | RGR       |
| DRAWN    | EMOMSGHT1 |
| CCMP     |           |
| CHECKED  |           |
| DATE     | 1-30-85   |

SHEET No.  
**12**  
**17**  
OF

3785.12C

3785.12C  
EIGHT MILE ROAD SPECIFIC PLAN  
Omni-Means  
2-21-04  
Note: Stays on Permanent File

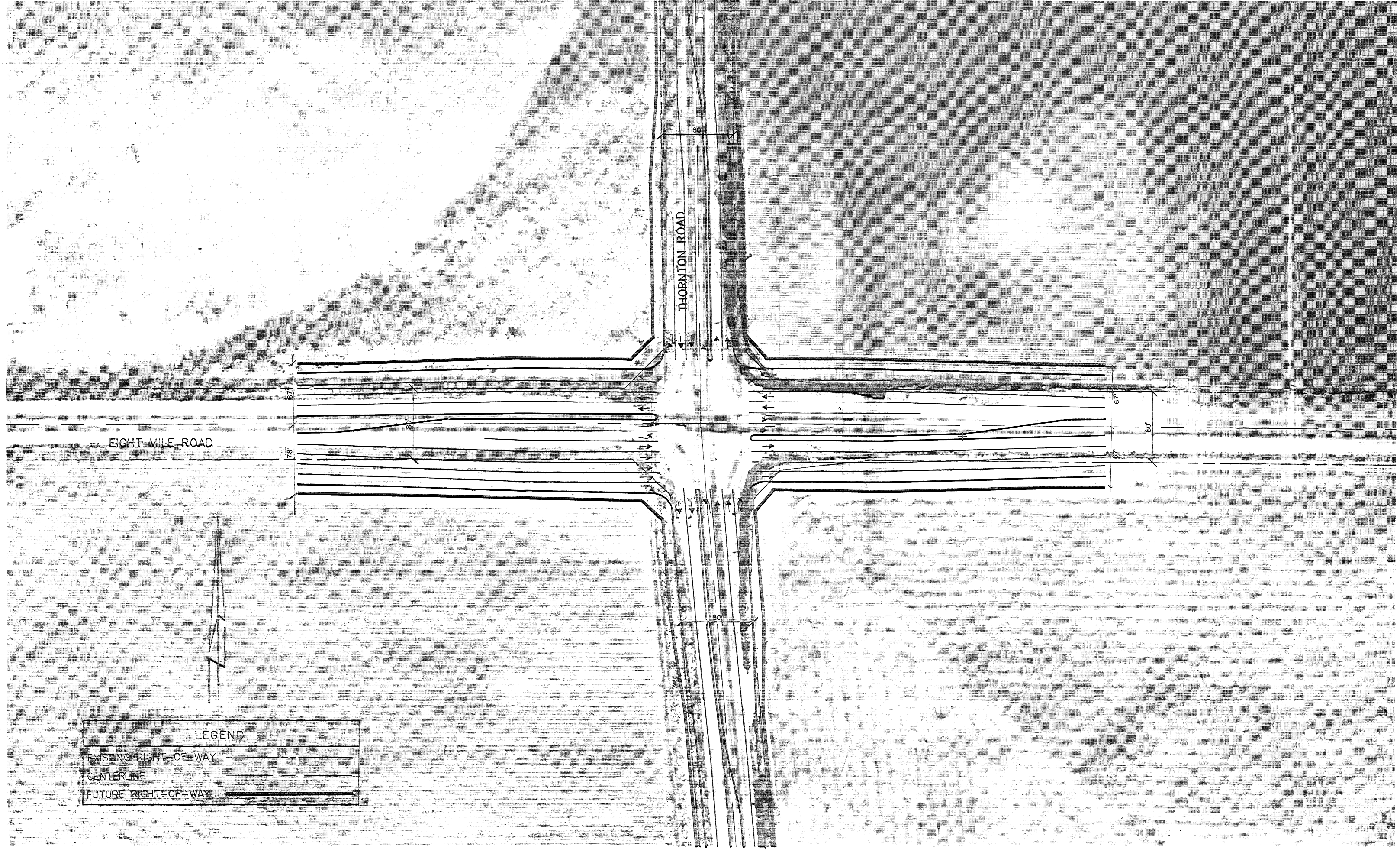

| LEGEND                |   |
|-----------------------|---|
| EXISTING RIGHT-OF-WAY | — |
| CENTERLINE            | — |
| FUTURE RIGHT-OF-WAY   | — |

| REVISIONS |          |      |    |
|-----------|----------|------|----|
| No.       | DESCRIP. | DATE | BY |
|           |          |      |    |
|           |          |      |    |
|           |          |      |    |
|           |          |      |    |
|           |          |      |    |

SCALE 1" = 50'

**omni-medians**  
ENGINEERS PLANNERS

1177 17th St., Suite 200  
San Joaquin County, CA 95317  
Tel: (209) 938-8888  
Fax: (209) 938-8889  
www.omni-medians.com

**EIGHT MILE ROAD SPECIFIC PLAN**  
SAN JOAQUIN COUNTY, CALIFORNIA

|          |         |
|----------|---------|
| JOB No.  | 3610-01 |
| DESIGNED | RGB     |
| DRAWN    | EMOMSH1 |
| COMP.    |         |
| CHECKED  |         |
| DATE     | 1-30-89 |

SHEET No.  
**13**  
OF  
**17**

3785.13C  
EIGHT MILE ROAD SPECIFIC PLAN  
FROM 1-5 to Hwy 99  
Omni-Medians 2-16-94  
Note: Stays on Permanent File

3785.13C

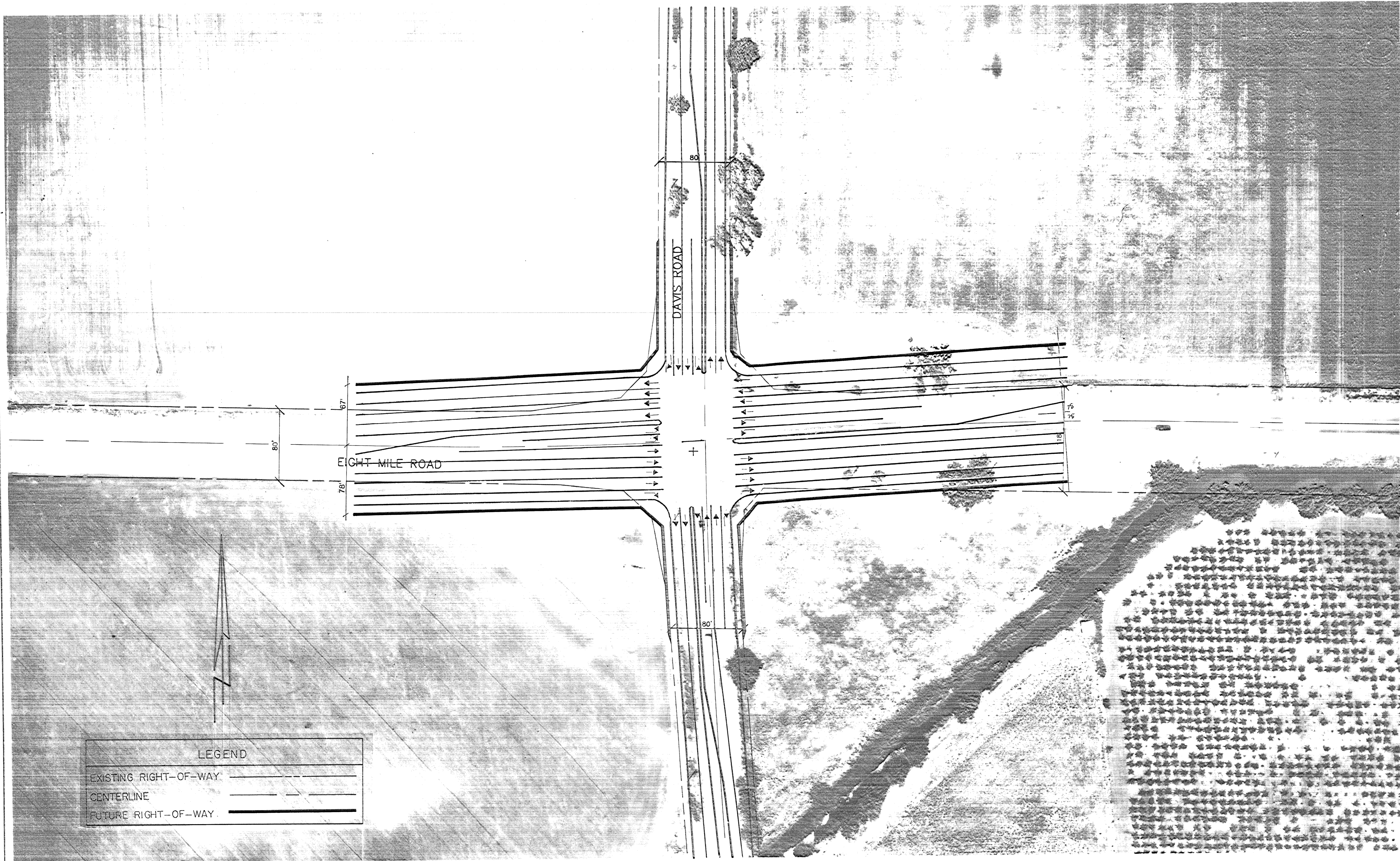

| LEGEND                |       |
|-----------------------|-------|
| EXISTING RIGHT-OF-WAY | ---   |
| CENTERLINE            | - - - |
| FUTURE RIGHT-OF-WAY   | —     |

| REVISIONS |          |      |    |
|-----------|----------|------|----|
| No.       | DESCRIP. | DATE | BY |
|           |          |      |    |
|           |          |      |    |

SCALE

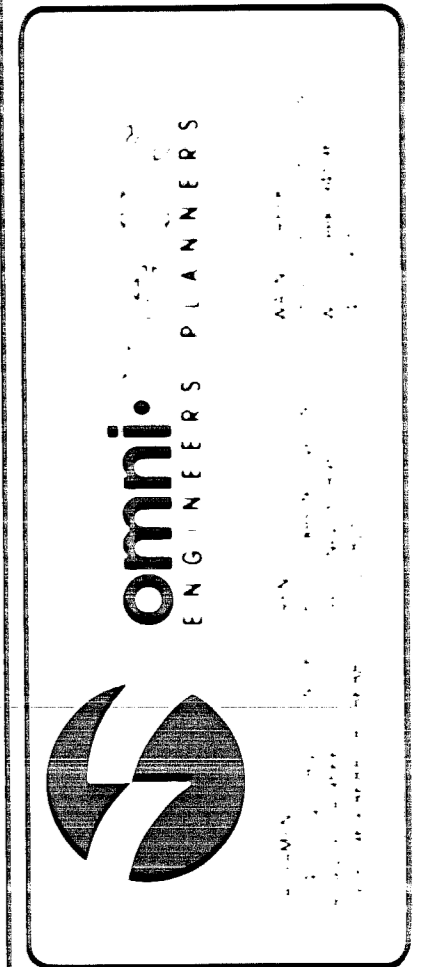

**EIGHT MILE ROAD SPECIFIC PLAN**  
 SAN JOAQUIN COUNTY, CALIFORNIA

|      |        |
|------|--------|
| DATE | 1-5-93 |
|------|--------|

14 / 17  
 OF

3785.14C

3785.14C  
 EIGHT MILE ROAD SPECIFIC PLAN  
 FROM I-5 TO Hwy 99  
 Omni means  
 NOTE: STAYS ON Permanent File

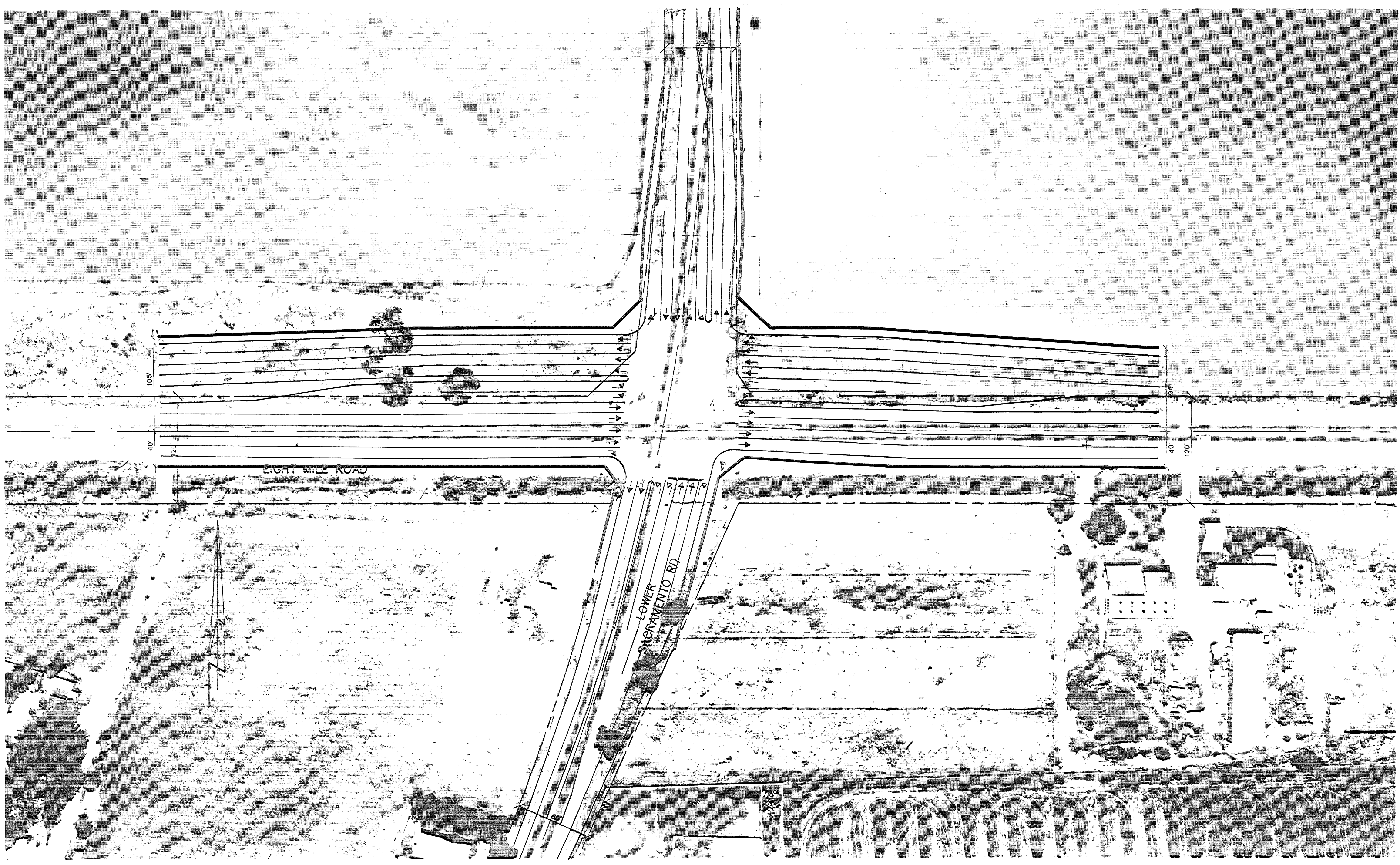

| REVISIONS |             |      |
|-----------|-------------|------|
| NO.       | DESCRIPTION | DATE |
|           |             |      |
|           |             |      |
|           |             |      |
|           |             |      |

SCALE 1" = 50'

**omni-means**  
ENGINEERS PLANNERS

1000 N. GARDEN ST. SUITE 100  
SACRAMENTO, CA 95833  
TEL: 916.442.1100  
FAX: 916.442.1101  
WWW.OMNI-MEANS.COM

**EIGHT MILE ROAD SPECIFIC PLAN**  
SAN JOAQUIN COUNTY, CALIFORNIA

|             |          |
|-------------|----------|
| JOB NO.     | 3785.15C |
| DESIGNED BY | RLB      |
| DRAWN BY    | TRUMPH   |
| CHECKED BY  |          |
| DATE        | 12.1.09  |

SHEET NO. 15 / 17

3785.15C  
EIGHT MILE ROAD SPECIFIC PLAN  
From I-5 to Hwy 99  
Omni-Means  
Notes: Stays on Permanent File

3785.15C



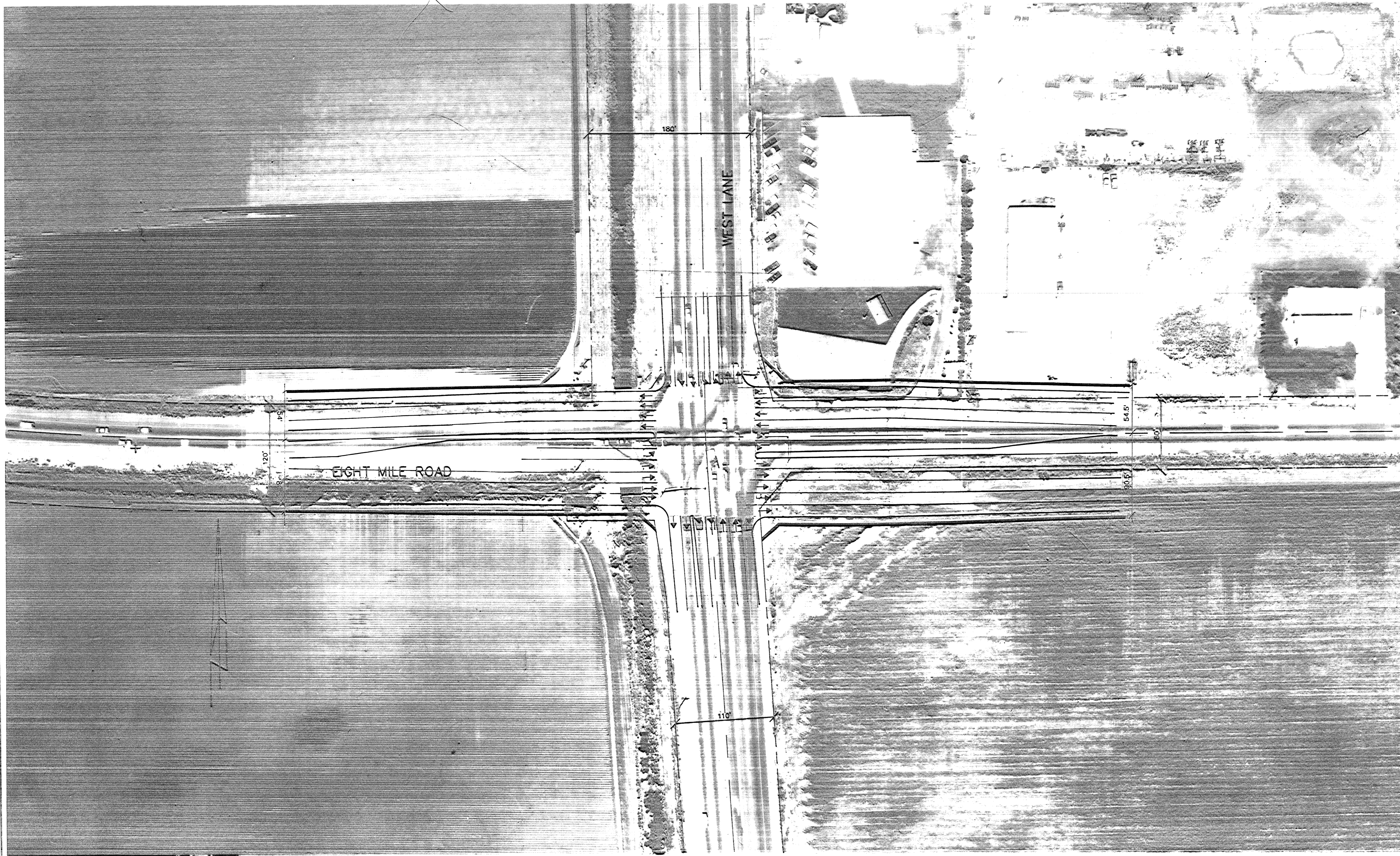

| REVISIONS |         |      |    |
|-----------|---------|------|----|
| No        | DESCRIP | DATE | BY |
|           |         |      |    |
|           |         |      |    |
|           |         |      |    |
|           |         |      |    |
|           |         |      |    |
|           |         |      |    |
|           |         |      |    |
|           |         |      |    |
|           |         |      |    |
|           |         |      |    |

SCALE 1" = 50'



SACRAMENTO, CALIF. 95811  
 916.952.8888 FAX 916.952.8886  
 1916  
 8121 Lakeside Drive, Ste. 100  
 Reno, Nevada 89511  
 (702) 825-1223  
 2500 Camino Diablo, Suite 270  
 Walnut Creek, CA 94596  
 (415) 935-1230

**EIGHT MILE ROAD SPECIFIC PLAN**  
 SAN JOAQUIN COUNTY, CALIFORNIA

|          |           |
|----------|-----------|
| JOB No   | 3610-01   |
| DESIGNED | RGB       |
| DRAWN    | EMOMSH11  |
| COMP     |           |
| CHECKED  |           |
| DATE     | 7/18/1988 |

SHEET No  
**16**  
 OF  
**17**

3785.16C  
 EIGHT MILE ROAD SPECIFIC PLAN  
 FROM 1-5 to Hwy 99  
 Omni-Means  
 2-16-94  
 Note: Stays on Permanent File

**3785.16C**

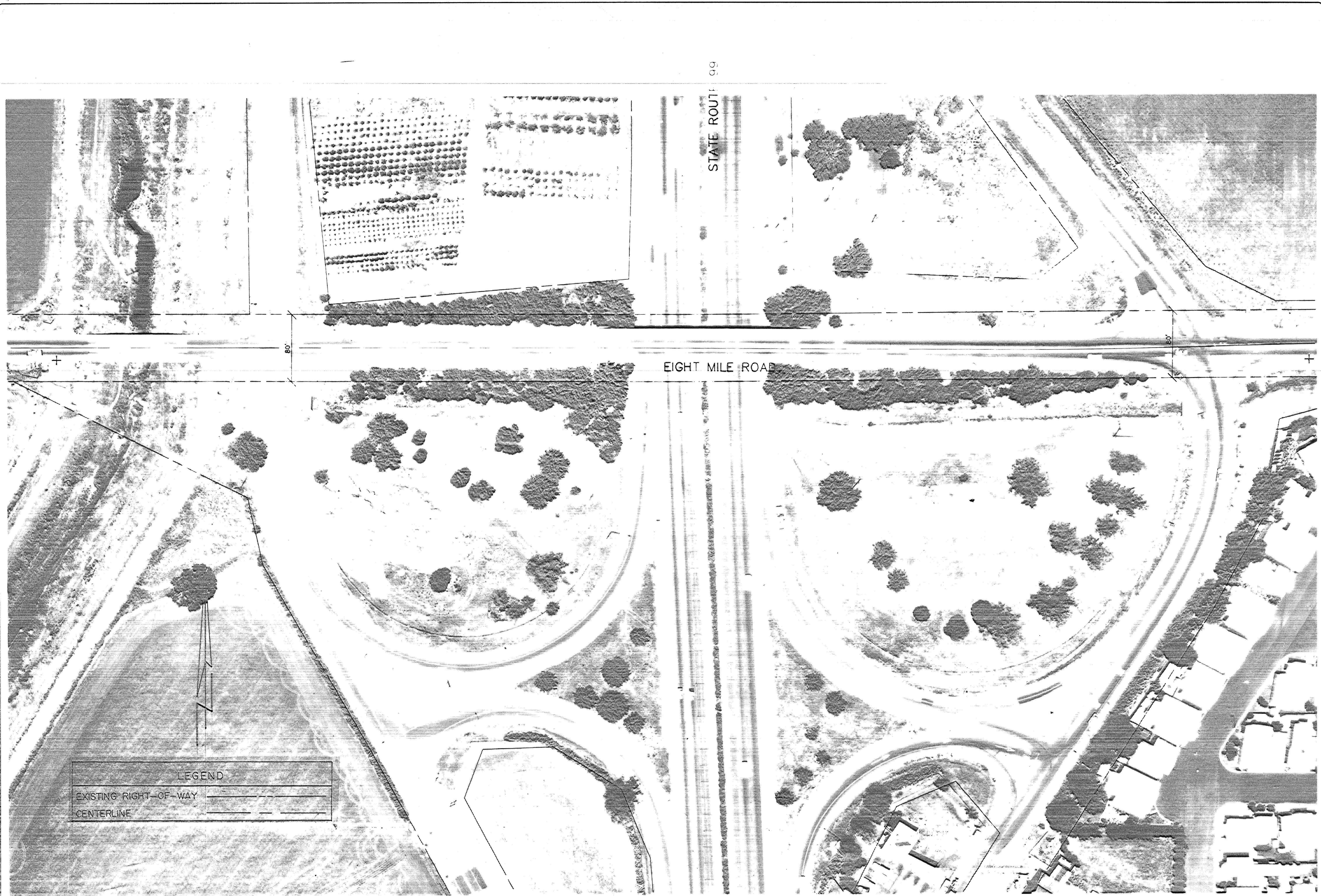

| REVISIONS |          |      |
|-----------|----------|------|
| NO.       | DESCRIP. | DATE |
|           |          |      |
|           |          |      |
|           |          |      |
|           |          |      |

SCALE 1" = 60'

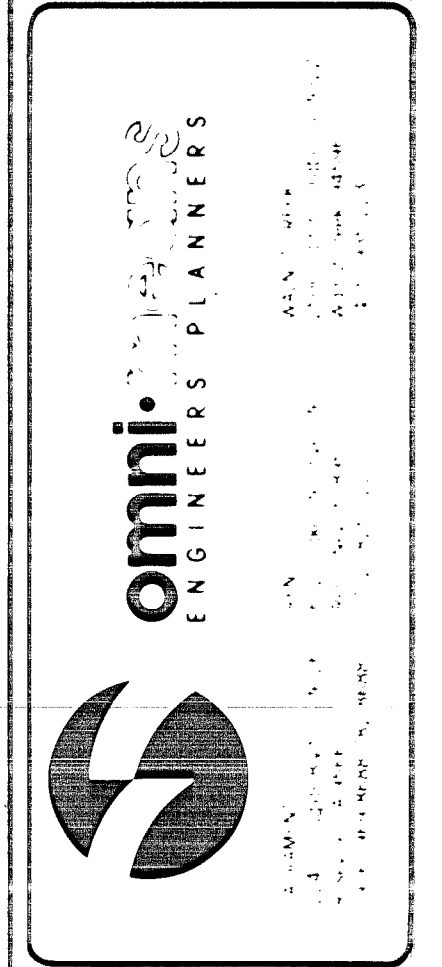

**EIGHT MILE ROAD SPECIFIC PLAN**  
 SAN JOAQUIN COUNTY, CALIFORNIA

JOB No. 3610-01  
 DESIGNED RGE  
 DRAWN EMOMSH\*1  
 CHECKED  
 DATE 1-30-84

SHEET No.  
 17 / 17  
 OF

3785.17C  
 EIGHT MILE ROAD SPECIFIC PLAN  
 FROM 1-5 TO HWY 99  
 OMNI-MEANS 2-16-94  
 NOTE: STAYS ON PERMAMENT FILE

3785.17C